



MARATHON HEATER

CERAMIC STRIP HEATERS



CERAMIC STRIP

FEATURES

- Marathon Ceramic Strip Heaters offer high temperature performance in a rugged, contamination resistant stainless steel sheath.
- They are bolt-in replacements for many of the Chromalox, GE, Watlow, and other strip heaters.
- Pricing is included in the Marathon CD and price book.



SPECIFICATIONS

- Max. Temperature = 1200°F
- Max watt density = 75 W/linear inch. 120 if 2 sides in contact with heated part
- Maximum Wattage: 120 Watts per inch of heated length, 75 if only one side is contacting the surface.
- 1½" wide, 5/16" or 3/8" thick, up to 72" long
- 5/16" x ½" mounting slots (center to center = overall length - 3/4)
- Maximum Voltage: 300V standard, 480V special
- Maximum Amperage (Leads) = 12 amps
- Maximum Amperage (Terminals) = 20 amps
- Wattage tolerance: +5%, -10%
- Resistance tolerance: +10%, -5%

OPTIONS

- S/S Braided leads for flexibility
- Button terminals
- S/S conduit for maximum lead protection
- Right angle exit available on any construction
- Dual voltage and 3 phase construction
- Spring guard upon request
- Built in thermocouple
- Europlug
- Terminal box
- Ground wire construction
- Custom mounting holes
- Ceramic terminal covers

WATT DENSITY

Watt Density formula for Strip Heaters

Wattage

(Heater Length - Cold) × Width

ORDERING INFORMATION

- Quantity
- Length and Width
- Volts/Watts
- Lead wire or Post Terminal Design
- Mounting holes or slots
- Special construction

UNHEATED LENGTHS

Heaters with Tabs

Heater Style	Unheated Left End	Unheated Right End	Heated = O.A.L. minus:
SN1	2 3/8"	1 1/4"	3 5/8"
SN2	3 1/8"	1 1/4"	4 3/8"
SN3	2 3/8"	2 3/8"	4 3/4"
SN4	3 1/8"	1 1/4"	4 3/8"
SL1	---	---	---
SB1	---	---	---
SL4	2 3/8"	1 1/4"	3 5/8"
SB4	2 3/8"	1 1/4"	3 5/8"
SC4	2 3/8"	1 1/4"	3 5/8"

Heaters WITHOUT Tabs

Heater Style	Unheated Left End	Unheated Right End	Heated = O.A.L. minus:
SN1	1 1/2"	1/4"	1 3/4"
SN2	2 1/4"	1/4"	2 1/2"
SN3	1 1/2"	1 1/2"	3"
SN4	2 1/4"	1/4"	2 1/2"
SL1	---	---	---
SB1	---	---	---
SL4	3/4"	1/4"	1"
SB4	3/4"	1/4"	1"
SC4	3/4"	1/4"	1"

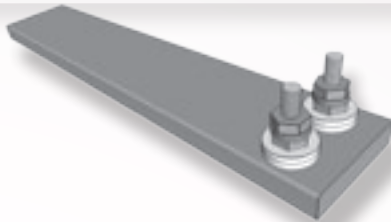

POST TERMINALS

TABS

NO TABS

SN1

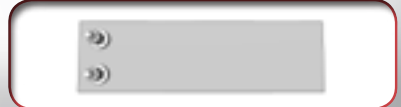

SN2

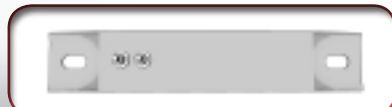

SN3



SN4

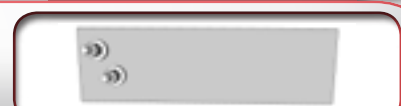
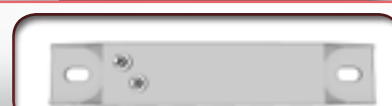

LEADS

TABS

NO TABS

SL1

~~SL1 NOT AVAILABLE WITH TABS~~

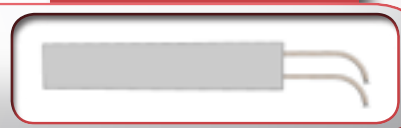

SB1

~~SB1 NOT AVAILABLE WITH TABS~~

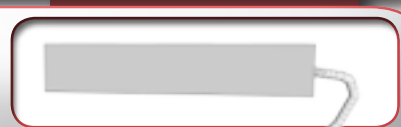

SL4
TGGT WIRE



SB4
SS BRAID



SC4
FLEX CONDUIT

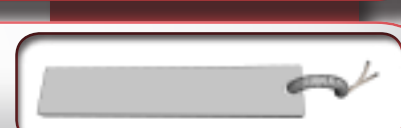

OTHER PRODUCTS

CARTRIDGE



AIR



TUBULAR



MICA BAND



CERAMIC BAND



TUBULAR BAND



REFRACTORY STRIP



MICA STRIP



CERAMIC STRIP



SILICONE RUBBER



REFRACTORY DISC



COIL



THERMOCOUPLE



Your Authorized Marathon Heater Representative is:

Marathon Heater 808 Hackberry Ln., Del Rio, TX, 78840. **Phone:** (830)-775-1417 **FAX:** (830)-775-4379

www.marathonheater.com

sales@marathonheater.com

Download our latest brochures at <http://www.marathonheater.com>

BR-CST-12

Revised 5 April 2012 © Marathon Heater Inc. All Rights Reserved.



Calculator

Main Site