

Model DWT

*Water Meter Actuated
Single and Dual Timers*

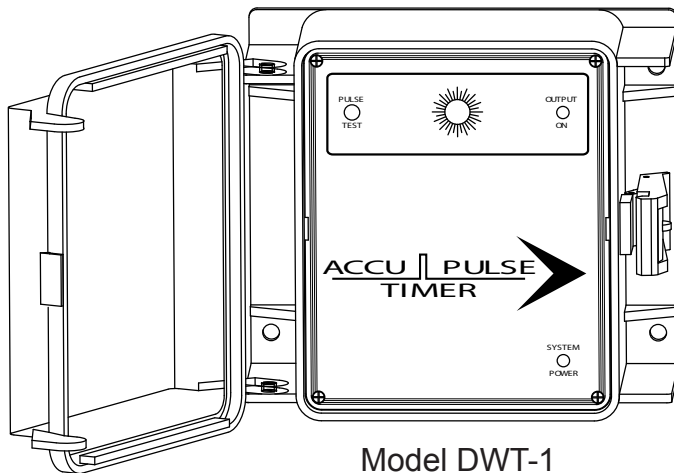

Model DWT-1

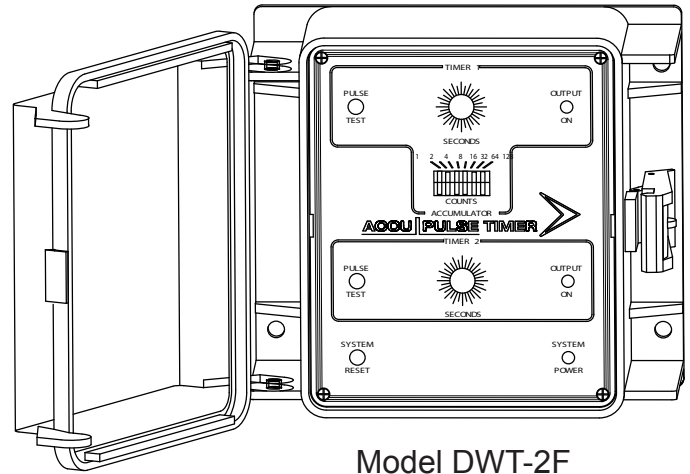

Model DWT-2F

Key Features

- NEMA 4X Type Enclosure
- Simple to Operate
- Precise Electronic Timing
- LED Indicator Lights
- Prewired Configuration
- Timer Test Switch
- Front Panel Settings
- Optional Accumulator
- 2 Year Warranty

Application

DWT timers provide accurate proportional control of relay outputs. Precise digital timer(s) are activated from an external dry contact switch device, such as a contacting head water meter.

Single or dual timer configurations are available. Front panel timer settings and a test switch provide easy set-up and operation. An optional accumulator circuit allows the timer to count up to 256 contacts before starting the time cycle.

Options

Your unit may be supplied with one or more options. Option codes will be shown at the end of model number. Example: DWT-1F.

- A** 0-10 minute scale (DWT-1)
- B** 0-10 minute scales (DWT-2)
- C** 0-10 minute, 0-150 second time scale (DWT-2)
- D** Other Time Scale - See price List
- E** Extra Female Output Cord
- F** Accumulator for DWT-1 or DWT-2
- G** Dual Accumulators for DWT-2
- H** Sequential Operation - DWT-2
- I** Two water meter inputs for separate timer operation (DWT-2 only)
- J** For 115 VAC Pulse Activator
- K** N.O./N.O. contacts
- L** Conduit Connections
- M** 240 VAC service
- W-1** 25 Amp Power Relays includes lower enclosure
- W-2** Dual 25 Amp Power Relays (DWT-2) includes lower enclosure
- X** HOA Switch for Relays

NOTE:

1. Units with W options are not prewired.

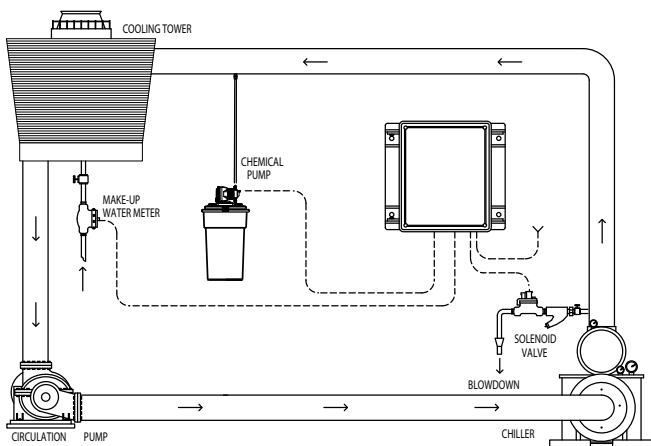

Typical Installation

Specifications

Electrical

- **Input:** 120 VAC, 60 Hz
 - **Control:** 120 VAC, 2.5 Amp resistive
- Prewired with 8' (243.84 cm) power cord and 11" (27.94 cm) output receptacles.

Input Required

- Dry switch closure from contacting head water meter or other device, 8' cord provided.
- Option J accepts 120 VAC contact input.

Timer Settings (Standard)

- **DWT-1:** 0-150 seconds
- **DWT-2:** 0-150 seconds both timers.
- Optional Accumulator, 2-256 counts, front panel adjustable.

Enclosure

Heavy duty NEMA 4X type high impact thermoplastic with padlockable gasketed Lexan viewing door.

Environment

- Ambient temperature: 0° to 140°F (-17 to 60°C)
Relative humidity: 0 to 100%

Shipping Weight: Approximately 4 lbs. (1.81 kg)

Dimensions:

W 7" (17.78 cm) x H 6.5" (16.51 cm) x D 4.5" (11.43 cm)

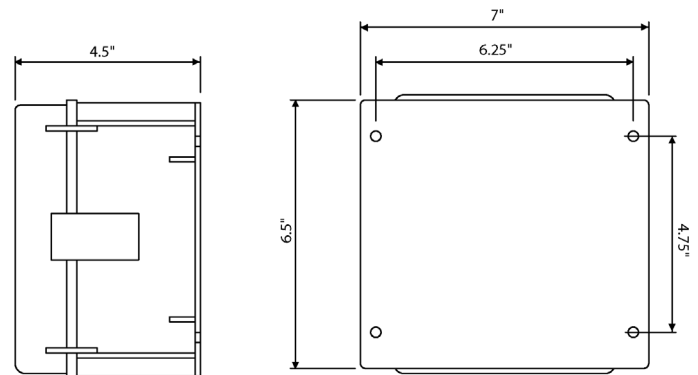

Get the Advantage



4700 Harold Abitz Dr
Muskogee, OK 74403
800-743-7431 phone
888-686-6212 fax
www.advantagecontrols.com